



EVEREST

Bottled Water Dispenser User Manual



- 1、 Hot Button
- 2、 Childproof Safety Switch
- 3、 Cold Button

- 4、 Drip Tray
- 5、 Cup Dispenser

■ Parts may not appear exactly as shown

THANK YOU FOR BUYING A CRYSTAL MOUNTAIN WATER COOLER!

RECEIVING

Inspect the cooler box immediately and carefully for any evidence of shipping or handling damage before signing to receive goods. In case of shipping damage, claims should be filed immediately with the carrier. Please note that the manufacture nor the carrier will not accept claims for any damage discovered after the signing for UNINSPECTED GOODS.

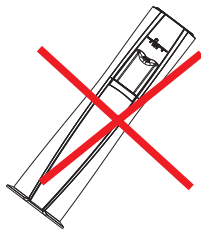

OPERATION

1. Place the water cooler on a flat level surface in a cool shaded location near a grounded wall outlet. Position water dispenser so that the back of the unit is a minimum of 2 inches / 5cm away from the wall to ensure proper ventilation (Figure 1).
2. Place the water bottle on top of the cooler appropriately (Figure 2).
3. Vent the hot tank by holding the hot faucet open until water flows out(Figure 3 and Figure 4).

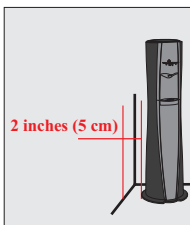

Figure 1

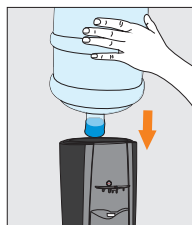

Figure 2

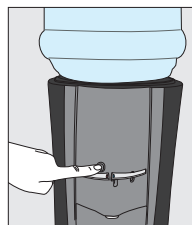

Figure 3

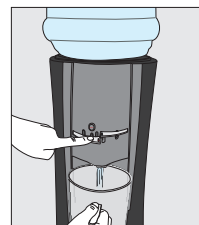

Figure 4

4. Ensure that the available power supply matches the cooler's voltage specifications indicated on the nameplate label (located at the rear). Plug power supply cord into receptacle(Figure 5). Please ensure that cooler is set up so as access to the power outlet and plug is unobstructed. Turn on heater switch(Figure 6).

Note: To provide additional protection from the risk of shock, this unit **MUST** be connected to a ground fault circuit interrupter (GFCI) outlet at all times. Use of an extension cord will void any warranties.

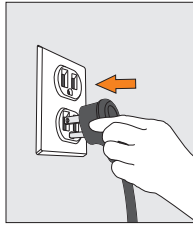

Figure 5

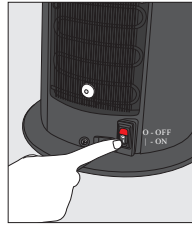

Figure 6

5. Do not draw water from the cooler for about 30 minutes to let the water cool or heat. Optimum water temperatures will be reached after several hours of operation (Figure 7 and Figure 8).

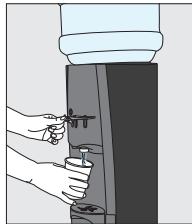

Figure 7

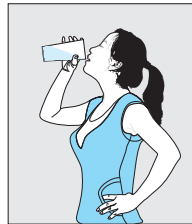

Figure 8

6. Ensure the following when cooler is to be serviced:

- 6.1 Turn off Hot Tank Switch and disconnect power supply cord (Figure 9 and Figure 10).

- 6.2 Remove bottle from reservoir (Figure 11).

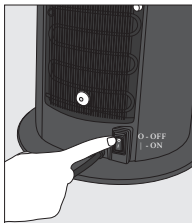

Figure 9

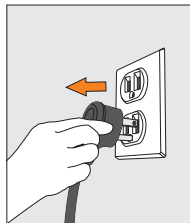

Figure 10



Figure 11

6.3 Use a bucket to drain water from the cold water reservoir through faucets (Figure 12). Turn off hot tank switch as above(Figure 13). Allow 1 hour for the hot water to cool down inside the hot water tank. Remove the drain plug at the rear of the cooler to drain in to a container (Figure 14 and Figure 15).

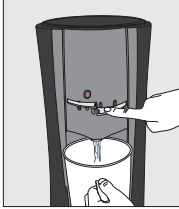

Figure 12

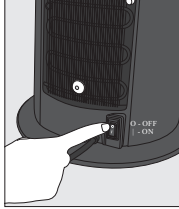

Figure 13

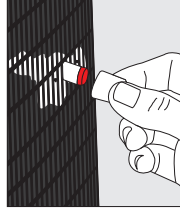

Figure 14

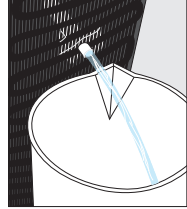
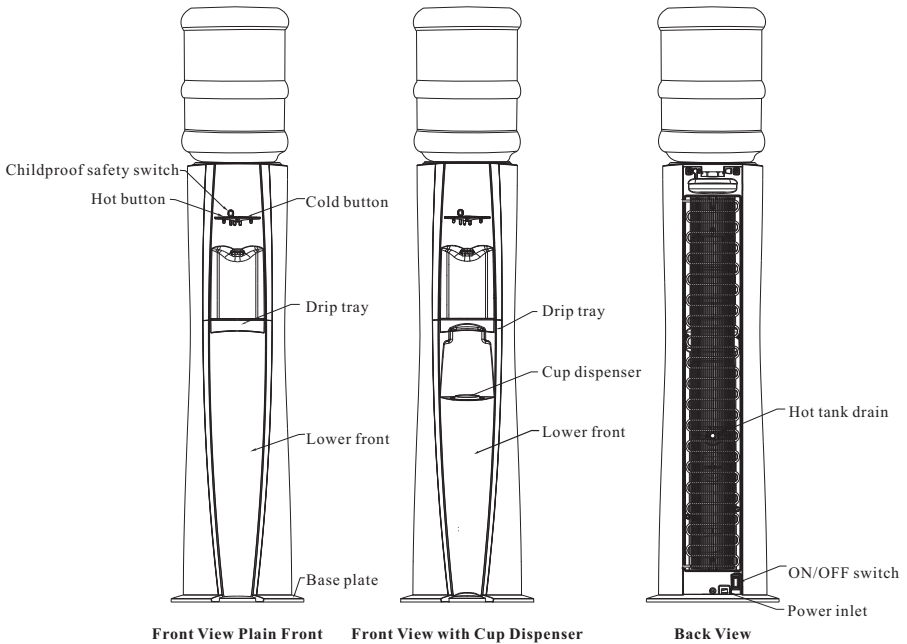

Figure 15

CAUTION! ALWAYS DRAIN WATER COMPLETELY BEFORE SHIPPING OR STORING THE COOLER!



CLEANING

Do not immerse the unit in water for cleaning

External: With the electrical power off (Figure 16), use only mild dishwashing liquid or cleaning products and a soft cloth for cleaning the exterior surfaces (Figure 17). DO NOT USE bleach or abrasive cleaners. Use a vacuum cleaner to remove dirt and lint from the condenser (Figure 18). The unit should be cleaned every 3 months, except where fingers touch the temperature selectors, which can be wiped often with hygienic wipes or mild food-grade disinfecting or cleaning products.

Caution: Do not clean unit with a water jet device.

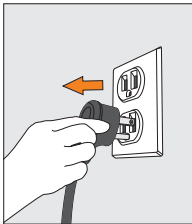

Figure 16

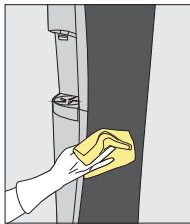

Figure 17

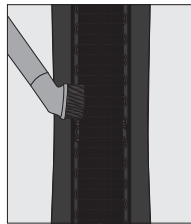

Figure 18

Internal: In the interest of hygiene it is recommended that the water cooler is cleaned every 6 months. Please contact your distributor for further information.

Caution: This operation should be carried out by properly trained personnel. Only use approved food-grade sanitizing products. The use of these products must be in accordance with the manufacturer's safety instructions and recommendations.

Everest Series Bracket Installation Instructions

INSTALLATION

1. Remove the two mounting screws that secure the upper support to the outer enclosure.
2. While holding the “S” shaped bracket against the cooler (refer to diagram) reinstall and tighten the upper support/outer enclosure screws securely.
3. Place the cooler in position against the wall and using the “S” bracket, mark the location of the wall insert holes to be drilled (if required). If not required, secure the cooler to the wall using the two screws provided.

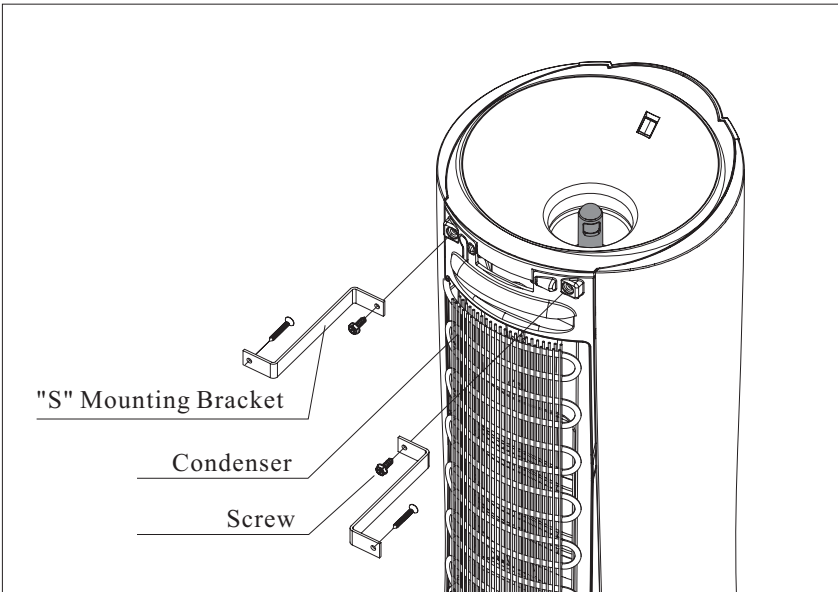

Figure 19

WARNING:

The warranty and Underwriters' Laboratory and CE listings for the coolers are invalidated if any alteration, modification, or use or misuse in combination with any other machine or devices is deemed to be the source of any claim. The manufacturer accepts no liability (including for bodily injury) resulting from any alteration, misuse, neglect, accidents, improper installations or repairs.

The Red Faucet dispenses hot water during normal operation that may cause severe burns.

This appliance is not intended for use by persons (including children) with reduced physical, sensory or mental capabilities, or lack of experience and knowledge, unless they have been given supervision or instruction concerning use of the appliance by a person responsible for their safety.

Children should be supervised to ensure that they do not play with the appliance.

If the supply cord is damaged, it must be replaced by a special cord or assembly available from the manufacturer or its service agent.



This marking indicates that this product should not be disposed with other household wastes throughout the EU. To prevent possible harm to the environment or human health from uncontrolled waste disposal, recycle it responsibly to promote the sustainable reuse of sustainable resources. To return your used device, please use the return and collection systems or contact the retailer where the product was purchased. They can take this product for environmental safe recycling.

The customer acknowledges that water, like other liquids, can cause damage to surfaces. The customer takes full responsibility for placing the cooler within a residence or business, and acknowledges that failure to address drips, leaks or spillages is at the customer's risk.

Environmental application temperature: 10~32°C.

The unit is rated IP10. (This unit is not protected against ingress of water)

For more information on this product, please visit www.crystalcoolers.com