



***ICEBERG***

*Undersink Water Dispenser User Manual*

## THANK YOU FOR BUYING A CRYSTAL MOUNTAIN WATER COOLER!

### **RECEIVING**

Inspect the cooler box immediately and carefully for any evidence of shipping or handling damage before signing to receive goods. In case of shipping damages, claims should be filed immediately with the carrier. Please note that the carrier will not accept claims for any damage discovered after signing for UNINSPECTED GOODS.

Ensure the cooler stands upright for 24 hours before plugging it in.

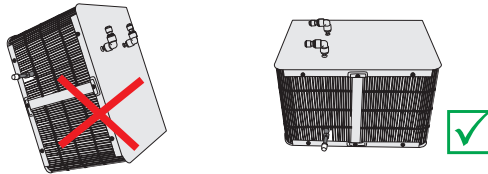

### **INSTALLATION / OPERATION**

System requirements

Water inlet pressure:

- Minimum 20 PSI (0.138 MPa)
- Maximum 80 PSI (0.552 MPa)
- Usage of a pressure regulator is advised anytime that pressure can reach higher than 80 PSI (0.552 Mpa) or if unit is installed above the ground floor.

1. The faucet assembly (Figure 1) (sold separately) should be appropriately and securely installed in the sink (Figure 2).
2. Place the cooler in a location in the cabinet under the sink with a minimum airspace of 127mm (5") around the unit to ensure ventilation (Figure 3) (see Figure 36). To provide the necessary air flow for the water cooler, two openings of at least 129 square cm (20 square inches) should be provided in the kitchen cabinet. The openings should be located as close to the cooler as possible. One should be made in the bottom of the cabinet and the other near the top. A cabinet vent should be used to cover the opening. Larger openings will always benefit the water cooler especially in higher ambient temperature conditions (Figure 4).

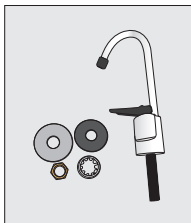

Figure 1

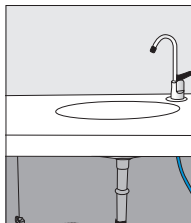

Figure 2

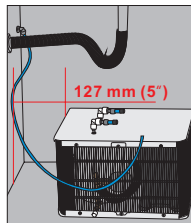

Figure 3

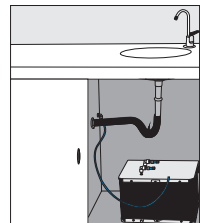

Figure 4

3. Flush the water line before installing the equipment. WATER IN tube to the unit should be plumbed directly from the mains potable water supply pipe nearest to the water cooler (Figure 5). Turn the water supply off (Figure 6). Cut the pipe and fit an appropriate tee piece to create a branch from the supply line. This tee piece should be as short as possible and terminated with an isolation/shutoff valve. Any accessories, such as filters, a leak detector, check valve (one way valve) and shutoff valve devices etc. can be fitted between this tee piece and the water cooler.

**Failure to use an appropriate leak detector and shutoff valve device for any reason will not obligate or make Crystal Mountain responsible in any way for Product Liability issues relating to any claims, including water damage claims.**

A shutoff valve should be used so that water can be shut off to isolate the unit with minimal inconvenience.

A one-way check valve should be included after the shutoff valve.

A leak detector and shutoff valve device should always be fitted (sold separately).

Where water supply pressures exceed 80 PSI (0.552Mpa), a pressure reducing valve should be fitted (sold separately).

The Shock Arrestor, if included on the unit, must be tested annually to ensure that it is functioning properly.

**Note: Maximum inlet water pressure is 80 PSI (0.552 Mpa).**

**Caution: Only properly trained personnel should carry out the installation of equipment to the mains water supply. Use only parts that meet local and national standards.**

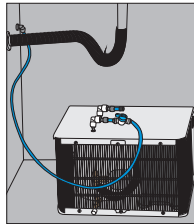

Figure 5

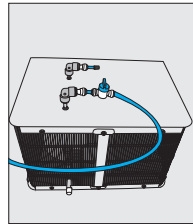

Figure 6

4. To fill the tank, open sink faucet first (Figure 7), then turn on the water supply valve (Figure 8). Continue to purge the water until the initial bubbling (air) disappears and a continuous water stream is observed.
5. Ensure that the available power supply matches the cooler's voltage specifications indicated on the nameplate label (located at the rear). Plug power supply cord into receptacle (Figure 9). Please ensure that cooler is set up so as access to the power outlet and plug is unobstructed.

**Note: To provide additional protection from the risk of shock, this unit MUST be connected to a ground fault circuit interrupter (GFCI) outlet at all times. Use of an extension cord will void any warranties.**

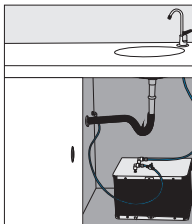

Figure 7

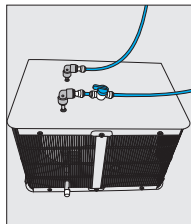

Figure 8

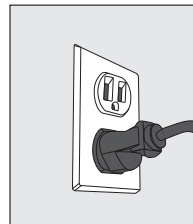

Figure 9

6. Water should not be drawn from the cooler for at least 30 minutes to allow time for water to chill. Optimum water temperature will be reached after several hours of operation.
7. Ensure the following when cooler is to be serviced or cleaned:
- 7.1 Turn off the electrical supply and disconnect the power cord (Figure 10).
  - 7.2 Close the shutoff valve, or shut off water supply to cooler (Figure 11).
  - 7.3 Release the pressure from the water system by opening the water faucet (Figure 12).

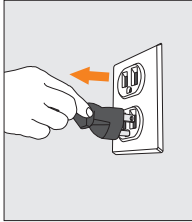

Figure 10

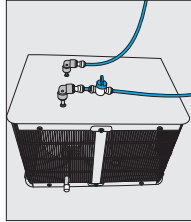

Figure 11

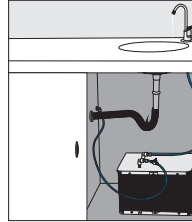

Figure 12

- 7.4 Undo the drain cap in the front of the cooler (Figure 13 and 14), and completely drain all the water from the reservoir into a bucket for disposal (Figure 15). Replace the drain cap (Figure 16). (Before the water cooler is returned to normal use, flush the reservoir thoroughly with clean, fresh potable water.)

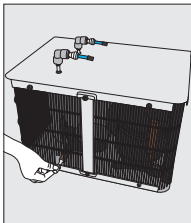

Figure 13

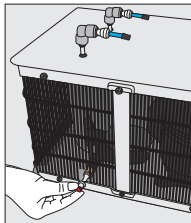

Figure 14

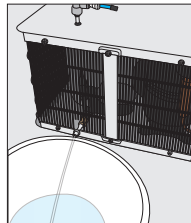

Figure 15

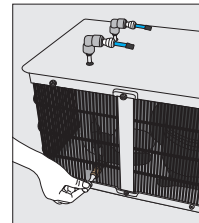

Figure 16

## **CLEANING**

To ensure that the cooler's warranty is not voided and to ensure safe operations of the cooler:

- **Never Immerse the Cooler in Water for Cleaning or Any other Reason**
- **Never Use a Pressure Washer/Power Washing Device to Service, Maintain or Clean the Cooler**
- **Follow all Instructions in this Manual**

**External:** With the electrical power off, use only mild dishwashing liquid or cleaning products and a soft cloth for cleaning the exterior surfaces. **DO NOT USE** bleach or abrasive cleaners. Use a vacuum cleaner to remove dirt and lint from the condenser (Figure 17 and Figure 18). The unit should be cleaned every 3 months.

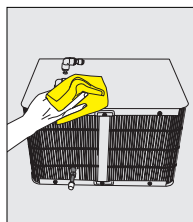

Figure 17

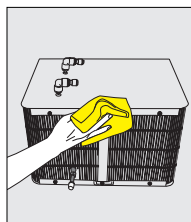

Figure 18

**Internal:**

- 1.1 Follow the instructions described in 7.1, 7.2 and 7.3 (Figure 19 to Figure 21) .

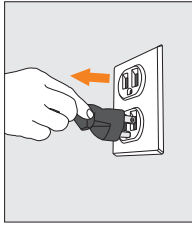

Figure 19

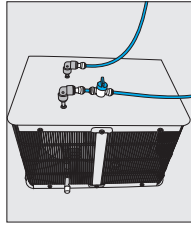

Figure 20

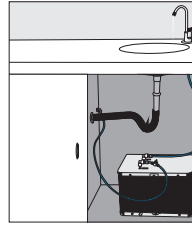

Figure 21

- 1.2 Disconnect the water line from the "Water Inlet" point (Figure 22). Undo the drain cap and completely drain all the water from the reservoir into a bucket for disposal (Figure 23). Leaving the faucet valve open will speed up this operation (Figure 24). Replace the cap (Figure 25). Disconnect filters and other devices so water line is clear to the reservoir.

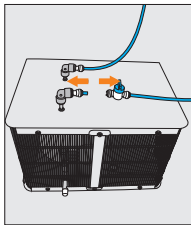

Figure 22

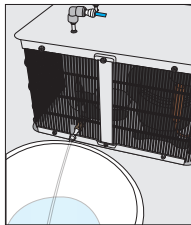

Figure 23

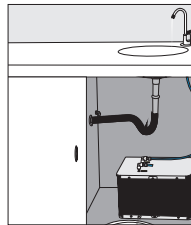

Figure 24

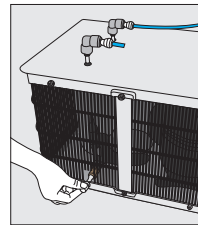

Figure 25

- 1.3 Using the water line removed from the "Water Inlet" (Figure 26), fill the reservoir with a recommended food grade sanitizing solution (Figure 27). (Please note that the solution should not be passed through any filters or associated equipment in the system - these should be disconnected prior to the solution being poured into the system, as per 1.2)

- 1.4 Allow the solution to remain in the system as recommended by the sanitizing product manufacturer. Remove the drain cap and drain all contents into a bucket for disposal (Figure 28).

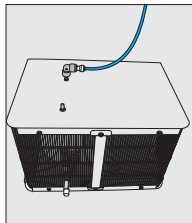

Figure 26

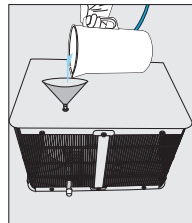

Figure 27

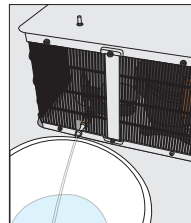

Figure 28

- 1.5 Reconnect the water inlet tubing (Figure 29) and partially turn on the water supply, allowing clean fresh water to flow through the unit into a bucket (Figure 30 and Figure 31). Repeat this step at least 3 times to remove all traces of sanitizing solution.

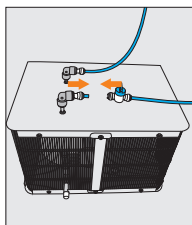

Figure 29

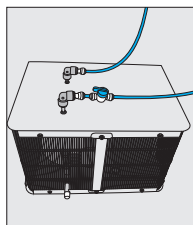

Figure 30

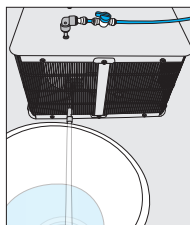

Figure 31

- 1.6 Turn off the water supply to the unit (Figure 32) and replace the drain cap (Figure 33).

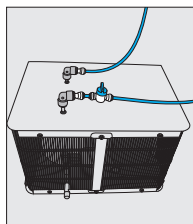

Figure 32

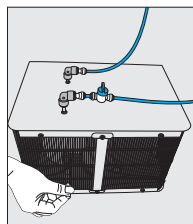

Figure 33

- 1.7 Complete the reconnecting of the water system, including any previously disconnected devices (in 1.3 above).
- 1.8 Turn on the water supply and allow water to flow uninterrupted through faucet for at least 3 minutes into the sink to ensure total flushing of the system (Figure 34 and Figure 35).

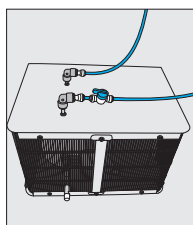

Figure 34

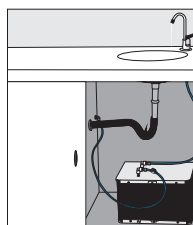
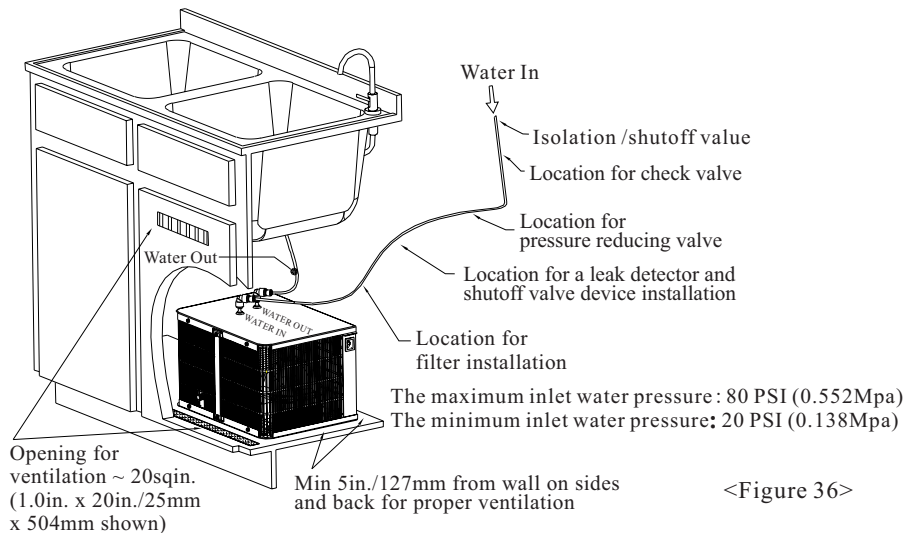

Figure 35

- 1.9 Dry off any water spillage from the vicinity of the water cooler.
- 1.10 Reconnect the electrical supply and switch on the unit to return to normal usage.

**CAUTION! ALWAYS DRAIN WATER COMPLETELY  
BEFORE SHIPPING OR STORING THE WATER COOLER**



## **TROUBLESHOOTING**

### **Water Leaks**

- If water dripping from system, shut off mains water supply valve, open dispensing valve to release pressure from the water lines and verify tubing is connected properly
- If water continues to leak, unplug dispenser, shut off mains water supply and call 1-800-878-6422 (North America sales) or +44(0)-1625-439-111 (UK/Europe sales) for assistance
- As part of good practice, tubing should be inspected regularly. If there is any evidence of damage, hardening or cracking it should be replaced immediately

### **Water Not Dispensing**

- Ensure that lever on dispensing valve is fully depressed

### **Not Cooling**

- Optimum cold water temperatures will be reached after several hours of operation
- Ensure that the dispenser is at least 5 inches (127mm) from the wall to provide sufficient ventilation
- Ensure that the cabinet has sufficient ventilation installed. 2 openings at least 20 square inches (129 square cm) should be provided in the kitchen cabinet. The openings should be located as close to the cooler as possible. One should be made in the bottom of the cabinet and the other near the top.

### **Dispenser is Noisy**

- Ensure that the dispenser is positioned on a flat, level surface

## **MAINTENANCE**

### **Please note that only properly trained personnel may perform service and maintenance.**

- Ensure that the system is disconnected from the mains power supply, cooled and system drained of water prior to performing maintenance or repairs.
- Check the Shock Arrestor Pre-Charge annually (minimum) to verify that the internal pressure is within 20% of the values indicated on the label (50 psi / 3.45 Bar if not otherwise stated).
- In order to maintain the external surface of the expansion tank, periodical cleaning shall be performed, only using water and soap.
- The Shock Arrestor is subjected to changes in system pressures, and may deteriorate over time; in the event that the Shock Arrestor no longer works, it should be replaced.

**Note:** To ensure the proper functioning of the system, the Shock Arrestor must be replaced in the event of excessive deterioration or every 5 years from installation date.

- Use only Crystal Mountain original replacement parts.

**CRYSTAL MOUNTAIN shall not be responsible for any damage to things, property and / or injuries to persons due to not observing all the above instructions and, particularly, operation and maintenance of the tank itself and / or the connected system.**

## WARNING

**To reduce risk of injury and property damage, user must read this entire guide before assembling, installation and operation of the dispenser.**

**Failure to follow the instructions in this manual can cause personal injury or property damage.**

**When operating this dispenser, always exercise basic safety precautions, including the following:**

- Prior to use, this dispenser must be assembled and installed in accordance with this manual
- Always ensure the water supply is potable (drinking) water.
- This appliance is intended to be used in household and similar applications such as
  - Staff kitchen areas in shops, offices and other working environments;
  - Farmhouses and by clients in hotels, motels and other residential-type environments;
  - Bed and breakfast type environments;
  - Catering and similar non-retail applications.
- This dispenser is intended for dispensing water only. Do NOT use other liquids. Never use any other liquid in the dispenser other than known and microbiologically safe mains supplied water.
- Do not use an extension cord. Use of an extension cord will void any warranties.
- To provide additional protection from the risk of shock, this unit MUST be connected to a ground fault circuit interrupter (GFCI) outlet at all times.
- If the supply cord is damaged, it must be replaced or assembled with matched power cord available from the manufacturer or its service agent.
- Always grasp plug and pull straight out from outlet. Never unplug by pulling on power cord.
- To protect against electric shock, do NOT immerse cord, plug, or any other part of dispenser in water or other liquids.
- This appliance is not intended for use by persons (child or adult) who would not reasonably understand the safe installation and operation of the appliance.
- Children should be supervised to ensure that they do not play with the appliance.
- Use with caution only.
- Repairs should only be performed by properly trained personnel. Please contact us at 1-800-878-6422 (North America sales) or +44(0)-1625-439-111(UK/Europe sales) for assistance.

The customer acknowledges that water, like other liquids, can cause damage to surfaces. The customer takes full responsibility for placing the cooler within a residence or business, and acknowledges that failure to address drips, leaks or spillages is at the customer's risk.

The Warranty and Underwriters' Laboratory and CE listings for the coolers are invalidated if any alteration, modification, or use or misuse in combination with any other machine or devices is deemed to be the source of any claim. The manufacturer accepts no liability (including for bodily injury) resulting from any alteration, misuse, neglect, accidents, improper installations or repairs.



This marking indicates that this product should not be disposed of with other household wastes throughout the EU. To prevent possible harm to the environment or human health from uncontrolled waste disposal, recycle it responsibly to promote the sustainable reuse of sustainable resources. To return your used device, please use the return and collection systems or contact the retailer where the product was purchased. They can take this product for environmentally safe recycling.

**Failure to use an appropriate leak detector and shutoff valve device for any reason will not obligate or make Crystal Mountain responsible in any way for Product Liability issues relating to any claims, including water damage claims.**

Environmental application temperature: 10–32°C.

The unit is rated IP10. (This unit is not protected against ingress of water)

For more information on this product, please visit [www.crystalcoolers.com](http://www.crystalcoolers.com)